

# Installation Manual

RENAULT TWINGO 5DR  
REN-TWIN-5-B



## COMPONENTS INCLUDED

## SHADES

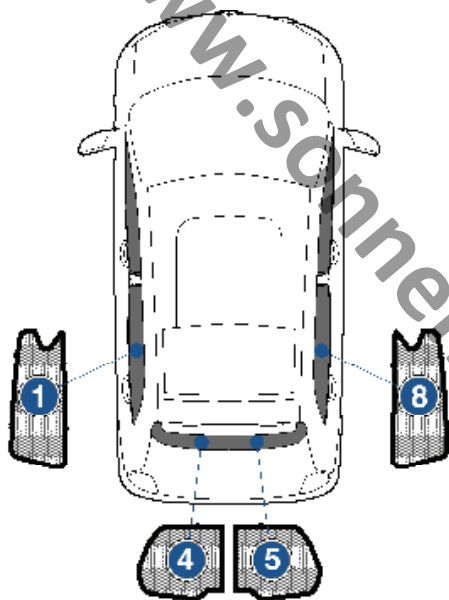

**CAR**  
SHADES

## FIXING CLIPS



CL-P02 x 10



CL-M14 x 2



CL-W01 x 1

# Side Shade Installation

RENAULT TWINGO 5DR  
REN-TWIN-5-B

## COMPONENTS NEEDED:



### STEP #1

CLEAN THE AREA WHERE CLIPS  
ARE TO BE MOUNTED (AS IN STEP 2)  
WITH THE SURFACE CLEANER  
SACHET PROVIDED



### STEP #2

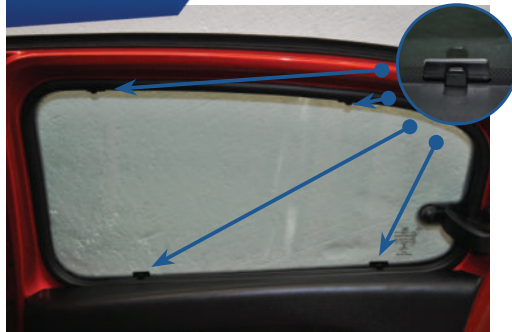

### STEP #3

POSITION THE SIDE SHADES

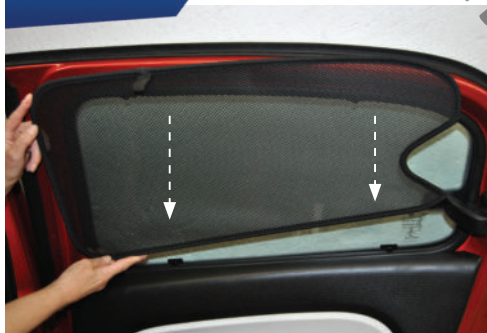

### STEP #4

ATTACH THE SHADES TO THE CLIPS



### STEP #5

ENSURE SECURELY FITTED IN PLACE

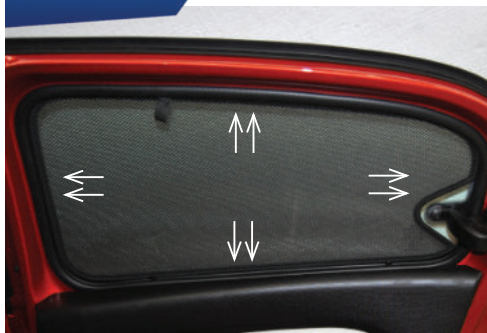

**CAR**  
SHADES

# Rear Shade Installation

RENAULT TWINGO 5DR  
REN-TWIN-5-B

## COMPONENTS NEEDED:



### STEP #1

CLEAN THE AREA WHERE CLIPS  
ARE TO BE MOUNTED (AS IN STEP 2)  
WITH THE SURFACE CLEANER  
SACHET PROVIDED



### STEP #2

PRESS THE CLIPS FIRMLY  
INTO PLACE AND ALLOW  
TO DRY FOR 20 MINUTES

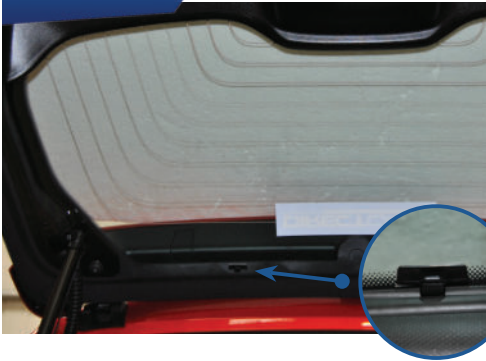

### STEP #3

POSITION THE REAR SHADES

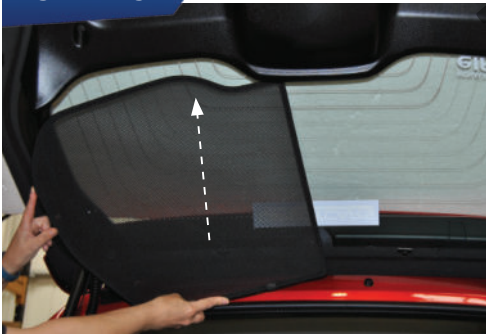

### STEP #4

INSERT CLIPS BEHIND INTERIOR TRIM

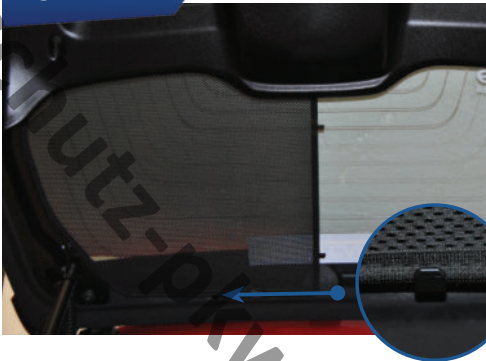

### STEP #5

REPEAT THE PROCESS ON OTHER SHADE



### STEP #6

ENSURE SECURELY FITTED IN PLACE

